

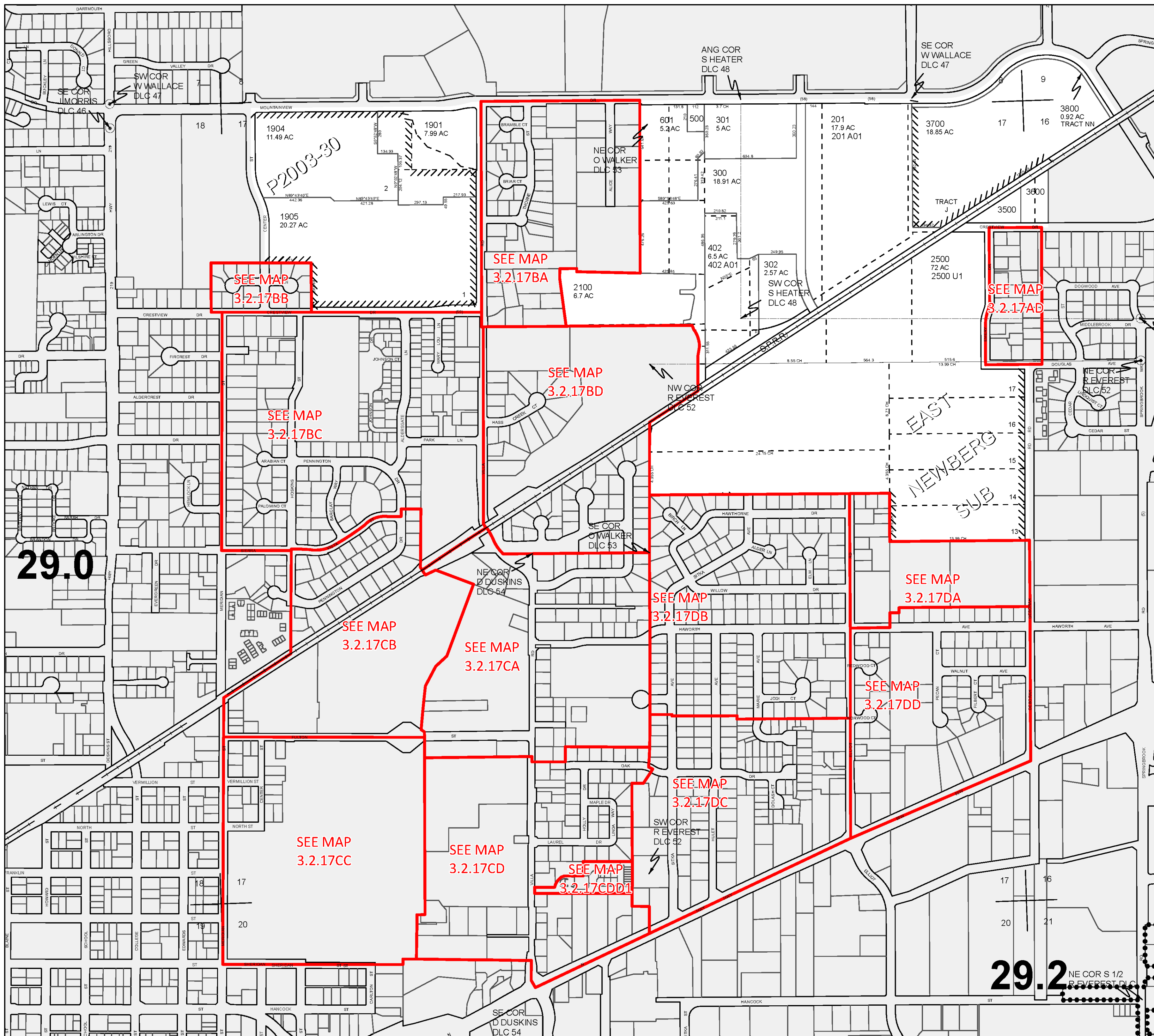

ASSESSMENT & TAX
CARTOGRAPHY

SECTION 17 T.3S. R.2W. W.M.
YAMHILL COUNTY OREGON
1" = 400'



CANCELLED TAXLOTS:

3700	2103	307
3400	2102	306
3306	2101	305
3305	2000	304
3304	1903	303
3303	1902	200
3302	1900	100
3301	1804	
3300	1803	
3200	1802	
3100	1801	
3004	1800	
3003	1700	
3002	1600	
3001	1500	
3000	1400	
2900	1300	
2800	1202	
2700	1201	
2602	1200	
2601	1100	
2600	1000	
2401	900	
2400	800	
2302	700	
2301	405	
2300	404	
2200	403	
2105	401	
2104	400	

DATE PRINTED: 5/19/2022

This product is for Assessment and Taxation (A&T) purposes only and has not been prepared or is suitable for legal, engineering, surveying or any purposes other than assessment and taxation.