

Exhibit O:
Zone Change Map and Legal Description



AKS ENGINEERING & FORESTRY, LLC
12965 SW Herman Road, Suite 100, Tualatin, OR 97062
P: (503) 563-6151 | www.aks-eng.com

AKS Job #4487-01

OFFICES IN: BEND, OR - KEIZER, OR - TUALATIN, OR - VANCOUVER, WA

EXHIBIT A

Description of Springbrook District Mid-Rise Residential Zone

Tracts A and B of the plat “Springbrook District”, recorded in Volume 15, Page 2, Yamhill County Plat Records, located in the Northwest One-Quarter of Section 17 and the Northeast One-Quarter of Section 18, Township 3 South, Range 2 West, Willamette Meridian, City of Newberg, Yamhill County, Oregon.

1/6/2023

EXHIBIT B

TRACTS A AND B OF THE PLAT "SPRINGBROOK DISTRICT",
LOCATED IN THE NORTHWEST 1/4 OF SECTION 17 AND
THE NORTHEAST 1/4 OF SECTION 18,
TOWNSHIP 3 SOUTH, RANGE 2 WEST, WILLAMETTE MERIDIAN,
CITY OF NEWBERG, YAMHILL COUNTY, OREGON

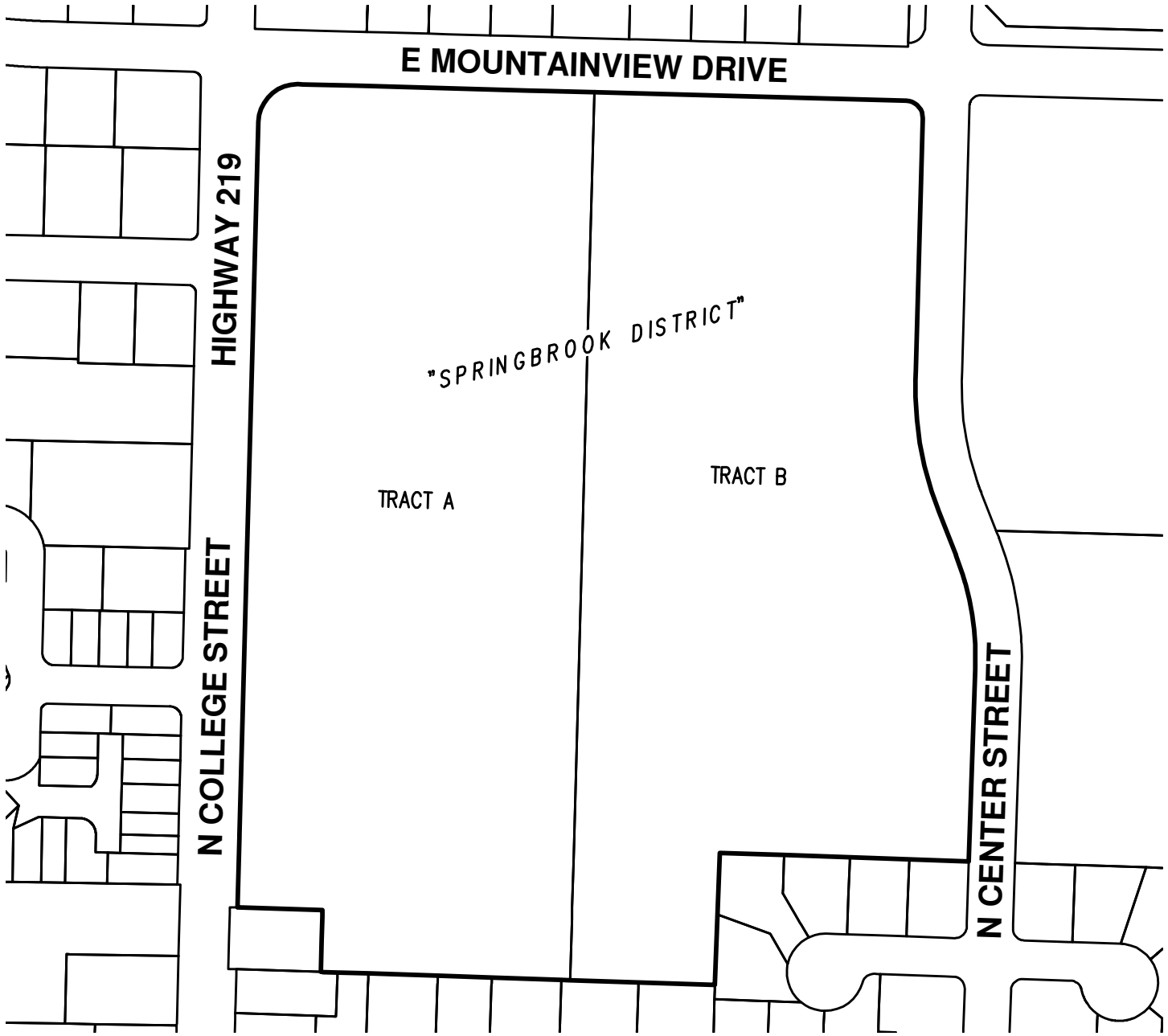

1/6/2023

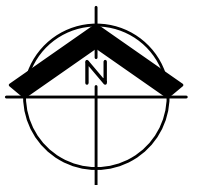
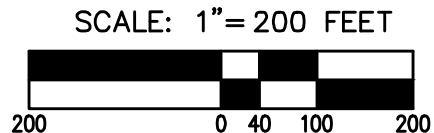

AKS ENGINEERING & FORESTRY, LLC
12965 SW HERMAN RD, STE 100
TUALATIN, OR 97062
503.563.6151 WWW.AKS-ENG.COM



MAP OF SPRINGBROOK DISTRICT
MID-RISE RESIDENTIAL ZONE

TL 3.2.18 00800 & 00900
DRWN: WCB CHKD: MSK
AKS JOB: 4487-01
EXHIBIT B