

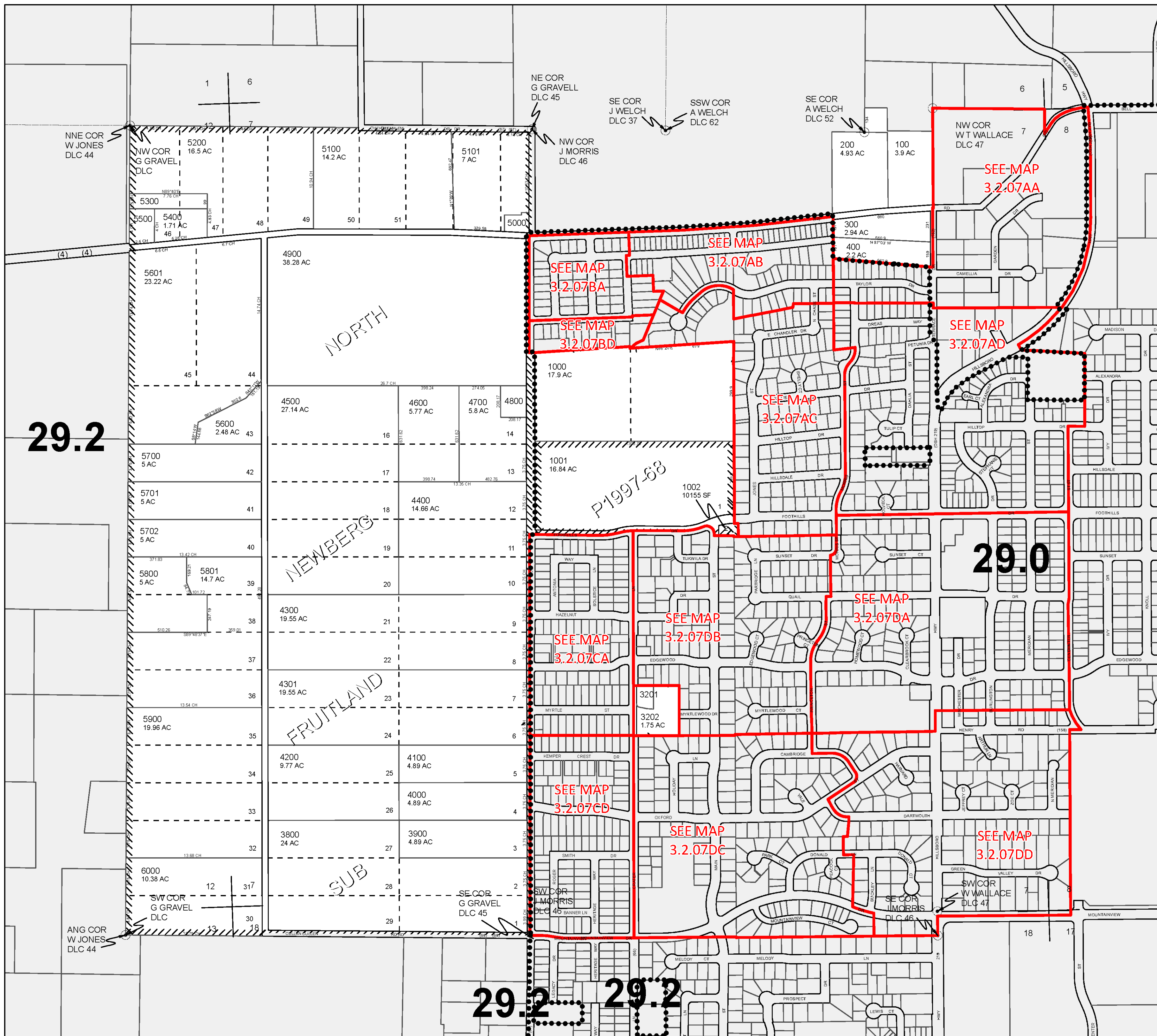

ASSESSMENT & TAX
CARTOGRAPHY

SECTION 7 T.3S. R.2W. W.M.
YAMHILL COUNTY OREGON
1" = 400'



CANCELLED TAXLOTS:

3704	1801
3703	1800
3702	1700
3701	1600
3700	1500
3600	1400
3500	1300
3400	1200
3300	1100
3203	1003
3200	500
3100	602
3002	700
3001	800
3000	600
2900	601
2800	
2700	
2600	
2503	
2502	
2501	
2500	
2400	
2300	
2200	
2100	
2000	
1901	
1900	

DATE PRINTED: 7/8/2021

This product is for Assessment and Taxation (A&T) purposes only and has not been prepared or is suitable for legal, engineering, surveying or any purposes other than assessment and taxation.